



**Transit Connection Corridor Project  
Project Number C2202, FA#: CDS 0815(007)  
Addendum #1**

**Issue Date:** April 16, 2026

**Bid Closing Date:** April 21, 2026, 2 p.m. Pacific Time

**QuestCDN Project:** eBidDoc Number 10106624

**NOTICE TO ALL PLAN HOLDERS:**

Bidders are hereby notified of the following additional information:

1. The second sentence of the first paragraph in the Invitation/Call for Bids is modified as follows:

“Bids will be received until 2:00 p.m., Pacific Time, on **Tuesday**, April 21, 2026”.

2. Appendix H – Traffic Control Plan is replaced with the renewed WSDOT Permit NWS 2575-MLT, see attached.

See additional information on the following pages.



All other elements of the Invitation/Call for Bids and Contract Provisions remain unchanged.

Bidders shall take this Addendum into consideration when preparing their bids. Bidders shall acknowledge receipt of this Addendum when submitting their bids.

**David M. Paul** Digitally signed by David M. Paul  
Date: 2026.04.15 15:39:43-07'00'

David M. Paul, PE,

City Engineer - Interim

## APPENDIX H - Traffic Control Plan



# General Permit (Application and Permit)

Applicant (hereinafter referred to as Permit Holder) City of Mountlake Terrace, Donnelle Dayao - Parks Project Manager				Permit Number <b>GP</b> NWS-2575-MLT	
Address 23204 58th Ave W				State Route 5	
City Mountlake Terrace	State WA	Zip Code 98043	Begin Milepost (if applicable) Left <input type="checkbox"/> Right <input type="checkbox"/> 178.26		End Milepost (if applicable) Left <input type="checkbox"/> Right <input type="checkbox"/>
Phone Number 425-744-6286		FED ID/SWW # n/a		Region Northwest	
Email DDayao@mltwa.gov				County King	
Project Name (if applicable) 236th Street Pedestrian Plaza					
Public Land Survey System (PLSS) At or begins at <input type="checkbox"/> NE 1/4 <input type="checkbox"/> NW 1/4 <input type="checkbox"/> SW 1/4 <input checked="" type="checkbox"/> SE 1/4 Section 32      Township 27-N      Range 4-E and if applicable ends at <input type="checkbox"/> NE 1/4 <input type="checkbox"/> NW 1/4 <input type="checkbox"/> SW 1/4 <input checked="" type="checkbox"/> SE 1/4 Section 32      Township 27-N      Range 4-E					
This General Permit shall apply to all Work being constructed by the permit on WSDOT right-of-way that is owned by or under WSDOT jurisdiction and includes all Work that will be WSDOT's responsibility to maintain when the Work is completed and accepted by WSDOT. (RCW 47.24.020 City Streets as part of State Highways.)					
Intended Use of WSDOT Highway Right-of-Way (hereinafter referred to as the "Work"): The implementation of traffic control within I-5 Limited Access.					
The Washington State Department of Transportation hereinafter will be referred to as "WSDOT." WSDOT will allow the Permit Holder to construct, upgrade, use, and/or maintain the Work described above provided the Permit Holder accepts all the terms, provisions, and exhibits attached hereto and by this reference made a part of this permit.					
Exhibit "A": General Permit Special Provisions		Exhibit "E": n/a			
Exhibit "B": Right of Way Sheet and/or Vicinity Map		Exhibit "F": n/a			
Exhibit "C": Traffic Control Plan					
Exhibit "D": n/a					
By signing below the Permit Holder accepts all the terms, provision, and exhibits attached to and made a part of this permit.					
<b>Permit Holder</b>			<b>WSDOT Approval</b>		
Print Name      Jeff Niten			Print Name Randy Frantz		
Print Title      City Manager			Print Title Development Services Assistant Manager		
Signature 			Signature Randy Frantz		
Date      10/17/2025			Date 10/13/2025		
			Expiration Date December 30, 2026		

Digitally signed by Randy Frantz  
DN: C=US, E=frantzr@wsdot.wa.gov, O=WSDOT, CN=Randy Frantz  
Date: 2025.10.13 12:46:19-07'00'

## General Provisions

*No changes to these General Provisions may be made without further approval of the Office of the Attorney General*

### DOCUMENTS, NON-EXCLUSIVE, COMPLIANCE WITH LAW, WORK

1. A copy of this Permit must be on the job site, protected from the elements, at all times during any Permit Holder activity, construction or improvement Work as authorized by this Permit. "Work" under this Permit shall include the use of WSDOT-owned right-of-way as authorized herein.
2. The Permit Holder shall be responsible for compliance with all applicable federal, state, tribal and local laws, ordinances and regulations, that affect work being performed pursuant to this Permit. The Permit Holder shall defend and indemnify WSDOT and the State of Washington against any claims that may arise because the Permit Holder (or any of its employees or subcontractors) violated a legal requirement.
3. The Permit Holder agrees that all Work shall be performed and completed to the satisfaction of WSDOT. All material and workmanship shall conform, in the sole discretion of WSDOT, to WSDOT's Standard Specifications for Road, Bridge, and Municipal Construction, current edition and amendments thereto, unless WSDOT has agreed in writing to a different standard, and shall be subject to WSDOT inspection. All WSDOT inspections of Work within WSDOT-owned highway right-of-way or upon state highway right-of-way under WSDOT jurisdiction, are solely for the benefit of WSDOT and not for the benefit of the Permit Holder, Permit Holder's contractor (if any), or any third party.
4. Upon approval of this Permit, the Permit Holder agrees to and shall diligently proceed with the Work and comply with all of the terms, provisions, and exhibits attached herein. Unless specified otherwise by WSDOT, or agreed to in writing by WSDOT, the work authorized by this Permit shall begin, be completed, or shall expire by the dates as agreed to by this Permit and its provisions, as indicated on page 1.

### RIGHT OF ENTRY NON-EXCLUSIVE

5. Subject to the terms of this Permit, WSDOT hereby grants to the Permit Holder, its authorized agents, contractors, subcontractors, and employees, a right of entry upon WSDOT-owned highway right-of-way or upon state highway right-of-way under WSDOT jurisdiction, onto which access is necessary to construct, operate and/or maintain the completed Work.

If WSDOT has approved any limited access breaks, or inner corridor access breaks, for the Work, the Permit Holder shall strictly comply with the terms and conditions of such approval.

### WSDOT NOTIFICATION: SURVEY MONUMENTS, HIGHWAY SIGNS, FENCES, LANDSCAPING

6. Unless authorized by WSDOT or other affected property owner in writing, the Permit Holder shall assure that all public and private property, including but not limited to traffic signal equipment, signs, guide markers, lane markers, fences, mailboxes, guardrail, barriers, and utilities, are not impacted, damaged, destroyed, or removed. If any such property is damaged, destroyed, or removed without prior written authorization, the Permit Holder shall notify WSDOT's representative immediately of such impact, damage, destruction or removal. The Permit Holder shall replace, repair, or fully restore any private or public property that is damaged, destroyed, or removed to WSDOT's sole satisfaction.
7. The Permit Holder shall not disturb, remove, or destroy any existing Survey Monument before first obtaining a Washington State Department of Natural Resources (DNR) permit. The Permit Holder agrees that resetting Survey Monuments shall be the sole responsibility, and at the sole expense, of the Permit Holder. Such resetting of any Survey Monument shall be performed by or under the direct supervision of a Licensed Professional Land Surveyor. The Permit Holder shall notify WSDOT in writing within ten (10) calendar days of any Survey Monument that has been disturbed, removed, destroyed, or reset, and shall restore the Survey Monument to its original place and condition at the Permit Holder's sole expense within ten (10) calendar days of its disturbance, damage or destruction.

If Permit holder does not perform the resetting work as required herein, WSDOT may perform such work and the Permit Holder agrees to fully reimburse and make payment to WSDOT within thirty (30) calendar days of the date of WSDOT's detailed invoice pursuant to Section 27 – Invoice and Payments, herein. If WSDOT chooses not to make the repairs, WSDOT may initiate an action to revoke this Permit.

A listing of Survey Monuments can be found at the WSDOT's Geographic Services Office Website:

<http://www.wsdot.wa.gov/monument/searchBroad.aspx>

## **DISTURBANCE OF EXISTING RIGHT-OF-WAY VEGETATION**

8. Unless otherwise authorized by WSDOT's representative in writing prior to the start of any Work, this Permit does not authorize the Permit Holder, its' employees, contractors, or agents, any right to cut, spray, retard, remove, destroy, disfigure, or in any way modify the physical condition of any vegetative or landscaping material located on WSDOT owned highway right-of-way or upon state highway right-of-way under WSDOT jurisdiction. Should the Permit Holder anticipate that its' Work will alter the appearance of WSDOT-owned highway right-of-way vegetation or landscaping material, the Permit Holder shall notify the WSDOT representative listed in Special Provision 1 to obtain WSDOT's prior written approval of the Permit Holder's proposed Work. If WSDOT allows the Permit Holder to modify WSDOT-owned highway right-of-way vegetation, it agrees that any vegetation cutting and/or trimming activities shall be conducted in such a manner that WSDOT-owned highway right-of-way vegetation and landscaping material appearance or functionality will not be altered or damaged. Should the Permit Holder alter or damage the appearance of WSDOT-owned highway right-of-way vegetation and landscaping without WSDOT's prior written approval, the Permit Holder is subject to penalties provided for in RCW's 47.40.070, 47.40.080, and 4.24.630, as applicable.

## **REMOVAL OF TIMBER**

9. This Permit is issued pursuant to the applicable terms of RCW 47.12.140 (Severance and Sale of Timber and other personalty - Removal of nonmarketable materials). This Permit does not authorize the Permit Holder, its' employees, contractors, or agents, any right to cut or remove any trees or timber located on WSDOT right-of-way or upon state highway right-of-way under WSDOT jurisdiction without prior written approval from WSDOT.

## **MERCHANDISING**

10. It is unlawful for any person to build, erect, establish, operate, maintain, or conduct along and upon the right-of-way of any state highway any platform, box, stand, or any other temporary or permanent device or structure used or to be used for the purpose of receiving, vending, or delivering any milk, milk cans, vegetables, fruits, merchandise, produce, or any other thing or commodity of any nature unless a permit therefore has first been obtained from WSDOT. WSDOT shall in each instance determine where any platform, box, stand, or any other temporary or permanent device or structure shall be permitted pursuant to RCW 47.32.110.

## **EROSION CONTROL AND DRAINAGE**

11. All discharges to WSDOT right-of-way or upon WSDOT highway right-of-way under WSDOT jurisdiction, if allowed, shall conform to State and Local water quality regulations and shall meet WAC 173-201A (Water Quality Standards for Surface Waters of the State of Washington).
12. During construction of this work, the Permit Holder shall comply with all provisions of the WSDOT Highway Runoff Manual, or WSDOT approved equivalent plan, and implement Best Management Practices (BMP's) to mitigate erosion.

## **CULTURAL RESOURCES**

13. If any archaeological or historical resources are revealed in the Work vicinity, the Permit Holder shall immediately STOP Work, notify WSDOT's Representative and retain a United States Government Secretary of the Interior's qualified archaeologist. Said archaeologist shall evaluate the site and make recommendations to WSDOT regarding the continuance of the Work.

## **COMPLIANCE WITH CLEARZONE GUIDELINES**

14. The Permit Holder hereby agrees that the Work described in this permit is in compliance with WSDOT's Clear Zone Guidelines pursuant to Chapter 1600 of WSDOT's Design Manual ([M 22-01](#)) and any revisions thereto. For any Work performed on a managed access state highway within an incorporated city or town, the Permit Holder may use the applicable city or towns clear zone guidelines if the city or town has their own published clear zone guidelines.

## **PERMIT EXTENSION AND ASSIGNMENT**

15. The expiration date of this Permit may not be extended without WSDOT's prior written approval.
16. This Permit shall not be deemed or held to be an exclusive one and shall not prohibit WSDOT from granting permits or franchise rights; or entering into other agreements with other public or private companies or individuals, nor shall it prevent WSDOT from using any of its highways, streets, or public places, or affect its right to full supervision and control over all or any part of them, none of which is hereby surrendered.

## **MAINTENANCE DEFICIENCIES**

17. The Permit Holder shall correct any maintenance deficiency related to, or contributed to in any way by, the Work within thirty (30) consecutive calendar days upon receiving written notice of such deficiency from WSDOT, unless WSDOT authorizes in writing a different time period. Should the Permit Holder fail to correct a deficiency within the prescribed time period after receiving written notice of the deficiency from WSDOT, WSDOT reserves the right to perform the necessary maintenance work to preserve WSDOT right-of-way or upon state highway right-of-way under WSDOT jurisdiction or for the protection of the traveling public including bicycles or pedestrians. If WSDOT performs maintenance work as provided herein, the Permit Holder agrees to fully reimburse and make payment to WSDOT within thirty (30) calendar days of the date of WSDOT's detailed invoice pursuant to Section 26 – Invoice and Payments, herein. If WSDOT chooses not to make the repairs; WSDOT may initiate an action to revoke this Permit.

## **INTERFERENCE WITH OTHER PROJECTS**

18. The Permit Holder agrees to schedule and perform the Work herein in such a manner as not to interfere with any WSDOT maintenance or other activities on WSDOT right-of-way or upon state highway right-of-way under WSDOT jurisdiction, including any WSDOT authorized construction activities that may be occurring in the general vicinity of the Work authorized by this Permit.

## **INSURANCE**

19. Insurance (Applicable on a case by case basis)

The Permit Holder shall provide proof of insurance coverage prior to performing any Work within State-owned highway right of way, as follows:

- Commercial General Liability covering the risks of bodily injury (including death), property damage, and personal injury, including coverage for contractual liability, with a limit of not less than \$5 million per occurrence and in the aggregate; OR
- Business Automobile Liability (owned, hired, or non-owned) covering the risks of bodily injury (including death) and property damage, including coverage for contractual liability, with a limit of not less than \$1 million per accident; OR
- Employers Liability covering the risks of Permit Holder's employees' bodily injury by accident or disease, with limits of not less than \$1 million per accident for bodily injury by accident and \$1 million per employee for bodily injury by disease.

WSDOT and the State shall be expressly named as an additional insureds under these general liability and automobile liability policies, by endorsing these policies with form CG2010 1185 or CA2048 (as appropriate), which shall contain no additional limitations with respect to completed operations or ongoing operations coverages, nor shall there be any limitation with respect to the negligence of WSDOT and the State. These policies shall be primary and non-contributory with respect to WSDOT and the State, and shall contain a waiver of subrogation in favor of WSDOT and the State. The Permit Holder shall furnish WSDOT proof of these insurance requirements prior to performing any Work under the Permit. A forty-five (45) calendar day written notice shall be given to the Department prior to termination of or any material change to the policy(ies) as such relate(s) to this Permit.

## **MODIFICATION OR REVOCATION OF THE PERMIT BY WSDOT**

- 20a. Modification: If this Permit is modified in writing by WSDOT, the Permit Holder will have thirty (30) calendar days from the date of the written notice to modify the Work as required by WSDOT. If the modifications cannot be made within thirty (30) calendar days, the Permit Holder shall request from WSDOT, in writing, during the prescribed time period, an extension of time in which to make the modifications. Any extension of time shall be made in writing and is solely within WSDOT's discretion.

Should the Permit Holder breach any of the conditions or requirements of the permit or if WSDOT determines that emergency maintenance of the Work is required to (1) protect any aspect of the state highway right-of-way or upon state highway right-of-way under WSDOT jurisdiction, or (2) secure the safety of the traveling public due to a failure of the Permit Holder's Work or its maintenance thereof, WSDOT may perform the emergency maintenance work without the Permit Holder's prior approval, and the Permit Holder agrees to reimburse WSDOT's actual direct and related indirect costs and expenses for performing the emergency maintenance work pursuant to the provisions of Section 27 - Invoice and Payments. WSDOT will notify the Permit Holder of the emergency work performed as soon as practicable.

20b. Revocation: If the Permit is revoked and the Permit Holder fails to return the property back to its original condition, as solely determined by WSDOT, WSDOT shall perform such Work at the Permit Holder's sole cost and expense, and the Permit Holder shall reimburse WSDOT's actual direct and related indirect costs and expenses for performing the Work pursuant to the provisions of Section 27 - Invoice and Payments.

20c. Plan Corrections: WSDOT reserves the right to require changes or corrections due to plan omissions or details not in conformance with WSDOT's Standard Specifications, Standard Plans, Design Manual, or Project Special Provisions.

## **MODIFICATION OF THE PERMIT BY THE PERMIT HOLDER**

21. If the Permit Holder desires to modify this permit and/or the Work, it shall notify the WSDOT Representative listed in Exhibit A, Special Provisions, in writing of all proposed changes for WSDOT's prior written approval. WSDOT agrees to provide written acceptance or rejection of the proposed change(s) to the Permit Holder within Ten (10) business days.

## **ADDITIONAL PERMIT CONDITIONS**

22. The Permit Holder shall not excavate or place any obstacle within the limits of state highway right-of-way in such a manner as to interfere with WSDOT's construction, operation, and maintenance of the State Highway right-of-way or the public's travel thereon without WSDOT's prior written approval and/or as may be provided in this Permit.

23. Upon completion of all Work, the Permit Holder shall immediately remove all rubbish and debris from WSDOT right-of-way or upon state highway right-of-way under WSDOT jurisdiction, leaving WSDOT right-of-way in a neat, presentable, and safe condition, to WSDOT's sole satisfaction. Any Work-related rubbish and debris clean up, or any necessary slope treatment to restore and/or protect WSDOT right-of-way or upon state highway right-of-way under WSDOT jurisdiction, not done within seven (7) calendar days of Work completion, will be done by WSDOT at the expense of the Permit Holder, unless otherwise approved in writing by WSDOT prior to the expiration of the (7) day period.

The Permit Holder agrees to reimburse WSDOT's actual direct and related indirect costs and expenses for performing the Work pursuant to the provisions of Section 27 - Invoice and Payments.

24. The Permit Holder agrees to maintain, at its sole expense, its Work under this Permit in a manner satisfactory to WSDOT, in WSDOT's sole discretion.

25. WSDOT shall in no way be held liable for any damage to the Permit Holder by reason of any such work by or authorized by WSDOT, its agents or representatives, or by the exercise of any rights by WSDOT upon roads, streets, public places, or structures in question.

## **EXTENSION OF THE EXPIRATION DATE**

26. If requested by the Permit Holder, the Expiration Date of this Permit may be extended by WSDOT after review of the contributing circumstances.

## **INVOICE AND PAYMENTS**

27. If WSDOT deems it necessary to perform Work as provided for in this Permit by WSDOT forces or its' contractor, including but not limited to any modification, repair, clean up or removal of the Work authorized under this Permit:

- a. WSDOT will assign a reimbursable account to the Permit Holder as a means of invoicing the Permit Holder for the costs associated with the Work performed by WSDOT.
- b. WSDOT will provide a detailed invoice, including direct and related indirect costs, to the Permit Holder for the Work performed by WSDOT or its contractor(s), and the Permit Holder agrees to pay WSDOT within thirty (30) calendar days of receipt of an invoice.
- c. The Permit Holder agrees that if payment is not made to WSDOT as herein agreed, WSDOT may charge late fees, interest and/or refer the debt to a Collection Agency, all in accordance with Washington State Law.

**OTHER PERMITS AND APPROVALS**

- 28. The Permit Holder shall be responsible for securing all necessary permits, including but not limited to, federal, state, and local regulatory, tribal, environmental, archeological, and railroad permits and permits from the Washington State Department of Ecology, the Washington State Department of Fish and Wildlife, and/or the U.S. Army Corps of Engineers prior to beginning the Work authorized by this Permit. The Permit Holder shall be responsible for mitigation measures where wetlands have been disturbed and agrees that it is solely responsible for any fines imposed for noncompliance with the permit(s) conditions or for failure to obtain the required permits. In addition, the Permit Holder, on behalf of itself and its contractors, officers, officials, employees, and agents, agrees to indemnify, hold harmless, and defend, at its sole cost and expense, WSDOT and its officers, officials, employees, and agents from any and all fines, costs, claims, judgments, and/or awards of damages to regulatory agencies, persons, and/or property, arising out of, or in any way resulting from, the Permit Holder's failure to (1) obtain any required permit for the Permit Holder Work or (2) comply with permit conditions.

**INDEMNIFICATION, WAIVER, VENUE, AND ATTORNEYS FEES**

- 29. The Permit Holder, its successors and assigns, shall indemnify, defend at its sole cost and expense, and hold harmless the State of Washington, its officers, employees, and agents from all claims, suits, demands, actions for damages (both to persons and/or property), expenses, regulatory fines, and/or suits in law and in equity that (1) arise out of or are incident to, or alleged to arise out of or are incident to, any acts or omissions of the Permit Holder, its agents, contractors, subcontractors, employees, invitees, successors, assigns and/or any other person in the use of the WSDOT-owned highway right-of-way or upon state highway right-of-way under WSDOT jurisdiction as authorized by the terms and conditions of this Permit, or (2) are caused by the breach of any of the terms or conditions of this Permit by the Permit Holder, its successors and assigns, and its contractors, subcontractors, agents, employees, invitees and/or any other person. The Permit Holder, its successors and assigns, shall not be required to indemnify, defend, or hold harmless the State of Washington, its' officers, employees and/or agents, if the claim, suit, or action for damages (both to persons and/or property) is caused by the sole acts or omissions of the State of Washington, its' officers, employees and/or agents; provided that, if such claims, suits, or actions result from the concurrent negligence of (1) the State of Washington, its officers, employees and/or agents, and (2) the Permit Holder, its agents, contractors, subcontractors, employees, invitees, successors, assigns and/or any other person or involves those actions covered by RCW 4.24.115, the indemnity provisions provided herein shall be valid and enforceable only to the extent of the acts or omissions of the Permit Holder, its agents, contractors, subcontractors, employees, invitees, successors, assigns and/or any other person.
- 30. The Permit Holder agrees that its obligations under this Permit extend to any claim, demand, and/or cause of action brought by, or on behalf of, any of its' employees or agents while performing Work under this Permit while located on or off WSDOT-owned highway right of way or upon state highway right of way under WSDOT jurisdiction. For this purpose, the Permit Holder, by mutual negotiation, hereby waives, with respect to the State of Washington only, any immunity that would otherwise be available to it against such claims under the Industrial Insurance provisions in chapter 51.12 RCW.
- 31. The indemnification and waiver provided for in Sections 29 and 30 shall survive the termination of this Permit.
- 32. In the event that the Permit Holder or WSDOT deems it necessary to institute legal action or proceedings to enforce any right or obligation under this Permit, the Permit Holder and WSDOT agree that any such action or proceedings shall be brought in the superior court situated in Thurston County, Washington. Further, the Permit Holder agrees that it shall be solely responsible for its own attorney's fees and costs and agrees that it shall not seek nor be entitled to recovery of such attorney's fees and costs.

**NONAPPLICABILITY OF RELOCATION ASSISTANCE/EMINENT DOMAIN**

- 33. The Permit Holder acknowledges that this Permit does not at any time entitle the Permit Holder, its successors or assigns, to assistance under the Relocation Assistance - Real Property Acquisition Policy (Chapter 8.26 RCW). Further, the revocation or other termination of this Permit shall not be deemed a taking by WSDOT under the laws of eminent domain.

**SPECIAL PROVISIONS**  
 County Projects on State Highways  
 City Projects on Limited Access State Highways

**Agreement Number: NWS-2575-MLT**

**The Agreement and these Special Provisions apply to all construction items within WSDOT jurisdiction and maintenance responsibility only.**

Applicable provisions are denoted by (  )

- 1. **WSDOT REPRESENTATIVE/NOTICE TO PROCEED.** *(Applicable to ALL Projects)*  
 No Improvements provided for herein shall be performed until the Agency is authorized by the following WSDOT representative:

**Mike Rudd, WSDOT Construction Representative**  
**WSDOT Northwest Region NB82-240**  
**15700 Dayton Avenue North**  
**PO Box 330310**  
**Seattle WA 98133-9710**  
**206-327-1877**  
[RUDDMIC@wsdot.wa.gov](mailto:RUDDMIC@wsdot.wa.gov)

- 2. **PLAN CHANGES** *(Applicable to ALL Projects)*
  - **AGENCY CHANGE ORDERS / ADDENDAS.** Changes to any previously Approved Plans affecting WSDOT-owned highway right-of-way or highway right-of-way under WSDOT jurisdiction must be reviewed and approved in writing by WSDOT prior to execution and implementation.
  - **WSDOT REQUIRED CHANGES OR CORRECTIONS.** WSDOT reserves the right to require changes or corrections due to plan omissions or details not in conformance with WSDOT's Standard Specifications, Standard Plans, Design Manual-Design Standards and/or Project Special Provisions.
- 3. **DELAY TO WSDOT CONTRACTS** *(Applicable to ALL Projects)*. The Agency agrees to schedule and perform the Improvements herein in such a manner as not to delay WSDOT's contractor in the performance of any WSDOT contract in the area. WSDOT shall in no way be held liable for any damage to the Agency or the Agency's contractor, by reason of any such work by WSDOT, its agents or representatives, or by the exercise of any rights by WSDOT upon any applicable roads, streets, public places, or structures.
- 4. **AMERICANS WITH DISABILITIES ACT (ADA) STANDARDS** *(Applicable to ALL New Construction and Alteration Projects)*. All public entities are required to follow *the Americans with Disabilities Act of 1990 (ADA)*, regardless of funding sources. Wherever pedestrian facilities are intended to be a part of the transportation facility, federal regulations require that those pedestrian facilities meet ADA standards. All new construction or alteration of existing transportation facilities must be designed and constructed to be accessible to and usable by persons with disabilities per Title II of the ADA (28 CFR Part 35.151) and Section 504 regulations (49 CFR Part 27.7(c)).

Neither cost nor schedule are factors in determining whether the ADA standards can be met, nor are they factors in determining the feasibility of complying with the standard. An alteration project must be planned, designed, and constructed so that the required accessibility improvements occur at the same time as the alteration.

The following are not considered Alteration Projects: Spot Pavement Repair, Liquid-Asphalt Sealing, Chip Seal (BST), Crack Sealing, and Lane Restriping that does not alter the usability of the shoulder.

If there is uncertainty as to whether a project meets the definition of an alteration project, WSDOT's Construction Representative and the Agency's Representative shall consult with WSDOT's Regional ADA Coordinator.

If a situation is encountered where it may not be possible to fully meet the applicable accessibility requirements during alterations of existing facilities, WSDOT's Construction Representative and the Agency's Representative shall consult with WSDOT's Regional ADA Coordinator in order to develop a workable solution to meet the accessibility requirements to the maximum extent feasible (MEF).

- 5. **TRAFFIC CONTROL AND PUBLIC SAFETY** *(Applicable to all City Projects within Limited Access Areas and/or City Projects within Managed Access Areas involving WSDOT maintained Traffic Signals, Freeway Ramps, or Ferry Traffic. Applicable to all other City Projects when WSDOT assistance is requested by the City. Applicable to all County Projects)*
  - **TRAFFIC CONTROL PLANS (TCPs).** Prior to construction and/or maintenance of this facility, the Agency shall submit Traffic Control Plans to WSDOT for Review and Approval at least ten (10) days in advance of the time that signing and other traffic control devices will be required. These TCPs shall be in compliance with The Manual on Uniform Traffic Control Devices (MUTCD) for Streets and Highways – Part 6 (Temporary Traffic Control) <https://mutcd.fhwa.dot.gov/pdfs/2009r1r2/part6.pdf> and Washington modifications thereto. All TCPs shall be site specific, unless allowed otherwise by WSDOT.
  - **MODIFICATION OR REVOCATION OF APPROVED TRAFFIC CONTROL PLANS.** WSDOT reserves the right to modify or revoke any Traffic Control Plan at any time due to unexpected emergencies or safety and operational problems for the traveling public. All costs and

time delays associated with modification or revocation shall be borne by the Agency. WSDOT shall in no way be held liable for any delays, costs, or other damages to the Agency by reason of any such WSDOT action.

- **PERMITTED HOURS FOR LANE CLOSURES / WSDOT NOTIFICATION.** The working hours within State owned highway right-of-way or highway right-of-way under WSDOT jurisdiction for this project are restricted per the Approved Traffic Control Plan(s). Any extension of these hours must be requested in writing and approved by the WSDOT in writing prior to construction. Weekend or Holiday (including Canadian Holidays-Skagit & Whatcom Counties) work is not permitted without prior written permission from the WSDOT. Five (5) working days written notification shall be given to the WSDOT's Representative prior to any lane closure.
- **SUSPENSION OF TRAFFIC CONTROL OPERATIONS.** WSDOT reserves the right to suspend all lane and shoulder closure operations due to unexpected emergencies or impediments to the flow of traffic. All costs associated with this suspension shall be borne by the Agency or their contractor.
- **HAZARD PROTECTION.** All hazards to vehicular, pedestrian, and bicycle traffic shall be marked by warning signing, barricades, and lights.
- **STORAGE OF EQUIPMENT AND MATERIALS.** All lanes shall be open and the shoulders shall be clear of construction equipment and materials during non-working hours. The Work Zone Clear Zone (WZCZ) applies during working and non-working hours. The WZCZ applies only to temporary roadside objects introduced by the Agency's operations and does not apply to pre-existing conditions or permanent Improvements. Those operations that are actively in progress shall be in accordance with adopted and approved Traffic Control Plans, and other Contract or Agreement requirements.

During nonworking hours, equipment or materials shall not be within the WZCZ unless they are protected by guardrail or barrier. The use of temporary concrete barrier shall be permitted only if WSDOT approves the installation and location.

During actual hours of work, unless protected as described above, only materials absolutely necessary to construction shall be within the WZCZ and only construction vehicles absolutely necessary to construction shall be allowed within the WZCZ or allowed to stop or park on the shoulder of the roadway.

Non-essential vehicles and employees' private vehicles shall not be allowed to park within the WZCZ at any time unless protected as described above.

Deviation from the above requirements shall not occur unless the Contractor has requested the deviation in writing, and WSDOT has provided written approval.

- 6. TRAFFIC CONTROL SUPERVISOR** *(Applicable to City Projects within Limited Access Areas; and/or City Projects within Managed Access Areas involving WSDOT maintained Traffic Signals, Freeway Ramps, or Ferry Traffic. Applicable to all County Projects).* The Agency or their Prime Contractor shall employ an individual or individuals to perform the duties of Full-Time Traffic Control Supervisor (TCS), certified by WSDOT. The TCS shall be responsible for safe implementation of Approved Traffic Control Plans. The TCS shall be present on the project whenever flagging, spotting, or other traffic control is being utilized. The TCS shall be responsible for having a current set of approved Traffic Control Plans, inspecting traffic control devices and nighttime lighting for proper location, installation, message, cleanliness, and effect on the traveling public. Traffic control devices shall be inspected at least once per hour during working hours. The TCS shall correct, or arrange to have corrected, any deficiencies noted during these inspections. The Agency or Prime Contractor shall maintain 24-hour telephone numbers at which the TCS can be contacted and be available on the job site within 45 minutes after notification from the WSDOT Representative at other than specified working hours.

**7. WORKER VISIBILITY** *(Applicable to Counties and Limited Access in All Cities)*

- **FLAGGER APPAREL.** Traffic Control Supervisors, Flaggers, Spotters, and others performing Traffic Control Labor of any kind shall comply with the following: (1). During daylight hours with clear visibility, workers shall wear a high-visibility ANSI/ISEA 107-2015 Class 2 or 3 vest or jacket, and hardhat meeting the high-visibility headwear requirements of WAC 296-155-305; and (2). During hours of darkness (½ hour before sunset to ½ hour after sunrise) or other low visibility conditions (snow, rain, fog, etc.), workers shall wear a high-visibility ANSI/ISEA 107-2015 Class 2 or 3 vest or jacket, high-visibility lower garment meeting ANSI/ISEA 107-2015 Class E, and headwear meeting the high-visibility headwear requirements of WAC 296-155-305.
- **APPAREL - OTHER CONTRACTOR PERSONNEL.** The Agency and/or the Contractor shall require all other personnel in WSDOT-owned highway right-of-way or highway right-of-way under WSDOT jurisdiction under their control (including Service Providers, Subcontractors, and lower tier Subcontractors) that are on foot in the Work zone and are exposed to vehicle traffic or construction equipment to wear the high-visibility apparel meeting Performance Class 2 or 3 requirements of the ANSI/ISEA 107-2015 publication titled "American National Standard for High Visibility Safety Apparel and Headwear".

**8. MATERIALS AND QUALITY ASSURANCE / QUALITY CONTROL (QA/QC)** *(Applicable to ALL Projects)*

- **MATERIALS AND WORKMANSHIP.** All materials and workmanship shall conform to the Washington State Department of Transportation Standard Specifications for Road, Bridge and Municipal Construction, current edition, and amendments thereto, and shall be subject to inspection by WSDOT.
- **APPROVAL OF MATERIALS –**  
**REQUEST for APPROVAL of MATERIALS (RAM).** The RAM shall be prepared by the Contractor or Agency in accordance with the instructions on Form 350-071 and submitted to WSDOT's Construction Representative for approval before the material is incorporated into the Improvements. All material, including proposed Aggregate Sources, shall be listed on the RAM Form. Approval of the material does not constitute acceptance of the material for incorporation into the Improvements. Additional acceptance actions as noted on the RAM

need to be completed prior to the materials being incorporated into the Improvements. When requesting approval of an item that requires fabrication, both the fabricator and the manufacturer of the base material shall be identified on the RAM.

**QUALIFIED PRODUCTS LIST (QPL).** The most current QPL list available at the time the product is proposed for use shall be used. The QPL submittal shall be prepared by the Contractor or Agency in accordance with the instructions in the QPL and submitted to WSDOT's Construction Representative prior to use. The QPL identifies the approved products, the applicable Specification Section, and the basis for acceptance at the project level. The acceptance and use of these products is based upon additional job sampling and/or documentation. All additional acceptance actions need to be completed prior to the material being incorporated into the Improvements. Qualified products not conforming to the Specifications, not fulfilling the acceptance requirements, or improperly handled or installed, shall be replaced at the Contractor's expense. If there is a conflict between the QPL and the Contract, the provisions of the Contract shall take precedence over the QPL. The current QPL can be accessed online at [www.wsdot.wa.gov/biz/mats/qpl/qpl.cfm](http://www.wsdot.wa.gov/biz/mats/qpl/qpl.cfm).

**AGGREGATE SOURCE APPROVAL (ASA).** All aggregates proposed for use on the project shall be from Pre-Approved WSDOT Sources. Pre-Approved Sources can be found on WSDOT's ASA database which contains results of WSDOT preliminary testing of aggregate sources. The ASA database can be accessed online at the agency website at: <http://www.wsdot.wa.gov/biz/mats/ASA/ASASearch.cfm>. This database is used by WSDOT to indicate the approval status of these aggregate sources for applications that require preliminary testing as defined in the Contract. The ASA 'Aggregate Source Approval Report' identifies the currently approved applications for each aggregate source listed. The acceptance and use of these aggregates is contingent upon additional job sampling and/or documentation. Aggregates approved for applications on the ASA 'Aggregate Source Approval Report' not conforming to the Specifications, not fulfilling the acceptance requirements, or improperly handled or installed, shall be replaced at the Contractor's or Local Agency's expense.

- **MATERIALS TESTING/REPORTING OF RESULTS.** All materials testing is to be performed by the Agency or an Independent Certified Testing Laboratory of their choice. Copies of all test results shall be submitted to WSDOT's Construction Representative prior to beginning the next phase of construction. WSDOT reserves the right to verify the test results or to perform the testing.
- **HOT MIX ASPHALT (HMA) DESIGN.** Prior to Paving Operations, the Agency shall submit WSDOT approved HMA Mix Design(s) from WSDOT's Qualified Products List (QPL) for use on this project.
- **PAVING OPERATIONS.** NO PAVING OPERATIONS WILL BE PERMITTED WHEN IT IS RAINING or SNOWING. Written permission from WSDOT's Construction Representative shall be required if paving operations begin before April 1<sup>st</sup>, or after October 1<sup>st</sup>. Surface temperature and other paving limitations as per WSDOT Standard Specifications shall be enforced.
- **MATERIAL TRANSFERING DEVICE / VEHICLE.** Direct transfer of HMA from the hauling equipment to the paving machine will not be allowed in the top 0.30 feet of the pavement section of hot mix asphalt (HMA) used in traffic lanes with a depth of 0.08 feet or greater. A material transfer device or vehicle (MTD/V) shall be used to deliver the HMA from the hauling equipment to the paving machine. HMA for pre-leveling, pavement repair, or HMA placed in irregularly shaped and minor areas such as road approaches, tapers, and turn lanes are excluded from this requirement. At the Contractor's request, WSDOT's Construction Representative *may* approve paving without an MTD/V. The MTD/V shall mix the HMA after delivery by the hauling equipment and prior to laydown by the paving machine. Mixing of the HMA shall be sufficient to obtain a uniform temperature throughout the mixture. If a windrow elevator is used, the length of the windrow may be limited in urban areas or through intersections, at the discretion of WSDOT's Construction Representative.
- **ROLLERS.** The type of rollers to be used and their relative position in the compaction sequence shall generally be the Contractor's option, provided the specified densities are attained. An exception shall be that pneumatic tired rollers shall be used for compaction of the wearing course beginning October 1st of any year through March 31st of the following year. Coverage with a steel wheel roller may precede pneumatic tired rolling. Operation of the roller shall be in accordance with the manufacturer's recommendations. The use of equipment that results in crushing of the aggregate will not be permitted. Rollers producing pickup, washboard, uneven compaction of the surface, or displacement of the mixture, or other undesirable results shall not be used.
- **JOINT SEALING.** All joints between existing and new pavement; or other cracks requiring repair shall be adequately cleaned and then sealed with PG 67-22 Liquid Asphalt in accordance with the manufacturer's recommendations. Filling shall be controlled to confine the material within the crack or joint. If, in the opinion of WSDOT's Construction Representative, the Contractor's method of filling results in an excessive amount of sealant on the pavement surface, filling shall be stopped and the method changed. Any overflow shall be cleaned from the pavement surface.
- **QUALIFICATION of CONCRETE SUPPLIERS.** Concrete Batch Plant Prequalification requires a certification by the National Ready Mix Concrete Association (NRMCA). A copy of that Certificate shall be submitted to WSDOT's Construction Representative prior to placement of cement concrete.
- **CONCRETE MIX DESIGN.** Prior to any placement of cement concrete, the Agency shall submit WSDOT approved Mix Design(s) for use on this Project to WSDOT's Construction Representative.
- **DRAINAGE STRUCTURES.** Only structures stamped APPROVED by the STATE's Materials and Fabrication Inspection Office shall be used on this project.

**9. UNSUITABLE MATERIALS** (*Applicable to ALL Projects*). If determined necessary by WSDOT, unsuitable material encountered during any excavation shall be removed and replaced to the satisfaction of WSDOT at the Agency's expense. The replacement material shall be free-draining and granular, or other materials as determined by WSDOT's Construction Representative in accordance with the Standard Specifications.

**10. EROSION CONTROL / DRAINAGE** (*Applicable to Counties and Limited Access in All Cities*).

- **BEST MANAGEMENT PRACTICES (BMP'S)**  
During construction of this project, the Agency shall comply with all provisions of the WSDOT Highway Runoff Manual or equivalent WSDOT approved plan and implement Best Management Practices (BMP's) as detailed in the manual to mitigate erosion.

- **WATER DISCHARGES ON THE PROJECT.** All discharges to WSDOT-owned highway right-of-way or highway right-of-way under WSDOT jurisdiction, if allowed on this project, shall conform to STATE and Local water quality regulations and shall meet WAC 173-201A (Water Quality Standards for Surface Waters of the State of Washington).
11. **INTERFERENCE TO WSDOT HIGHWAY DRAINAGE** (*Applicable to Counties and Limited Access in All Cities*). If the Improvements done under this Agreement interferes in any way with the drainage of WSDOT highway, the Agency shall wholly and at its own expense make such provision - as WSDOT may direct, to address the said drainage.
12. **DRAINAGE AND UTILITY CONSTRUCTION** (*Applicable to Counties and Limited Access in All Cities*)
- **PIPE END TREATMENT.** All culvert pipes shall have beveled end sections and quarry spalls shall be placed around end of pipes in the bottom of the ditch, and on the side of the slopes.
  - **UTILITY COVER ELEVATION.** All manholes, valve covers, and like appurtenances shall be constructed at such an elevation to conform to the shoulder slope from the edge of pavement or as directed by WSDOT.
  - **DRAINAGE STRUCTURES.** Only structures stamped APPROVED by WSDOT's Fabrication Inspection Office shall be used on this project.
13. **LANDSCAPING ON WSDOT RIGHT-OF-WAY** (*Applicable to Counties and Limited Access in All Cities*)
- **PLANTINGS.** If the Agency desires to plant and/or cultivate any shrubs, trees, hedges, or other domestic or native ornamental growth on WSDOT-owned highway right-of-way that is more extensive than regular WSDOT vegetation, the Agency shall obtain a Roadside Vegetation Permit (DOT Form 220-018) from WSDOT for the maintenance of the plantings.
  - **IRRIGATION SYSTEMS.** If the Agency desires to install an irrigation system, the Agency may be required to obtain additional approval. The Agency shall be responsible for water and electrical costs.
14. **DISTURBANCE OF EXISTING RIGHT-OF-WAY VEGETATION** (*Applicable to Counties and Limited Access in All Cities*). Unless otherwise authorized by WSDOT's representative in writing prior to the start of any Improvements, this Agreement does not authorize the Agency, its' employees, contractors, or agents, any right to cut, spray, retard, remove, destroy, disfigure, or in any way modify the physical condition of any vegetative or landscaping material located on WSDOT-owned highway right-of-way or upon state highway right of way under WSDOT jurisdiction. Should the Agency anticipate that its' Improvements will alter the appearance of WSDOT-owned Highway right-of-way vegetation or landscaping, the Agency shall notify the Department Representative listed in Special Provision 1 to obtain WSDOT's prior written approval of the Agency's proposed Improvements. If WSDOT allows the Agency to modify WSDOT-owned highway right-of-way vegetation, it agrees that any vegetation cutting and/or trimming activities shall be conducted in such a manner that WSDOT-owned Highway right-of-way vegetation and landscaping appearance or functionality will not be altered or damaged. Should the Agency damage or alter the appearance of WSDOT-owned Highway right-of-way vegetation or landscaping without WSDOT's prior written approval, the Agency is subject to penalties provided for in RCW's 47.40.070, 47.40.080, and 4.24.630, as applicable.
15. **RIGHT-OF-WAY RESTORATION** (*Applicable to Counties and Limited Access in All Cities*). Upon completion of all Improvement's, the Agency shall immediately remove all rubbish, scraps, brush, timber, waste materials, or other debris etc. from WSDOT-owned highway right of way, leaving the right of way in a safe, neat, and presentable condition to the WSDOT's sole satisfaction. The aesthetics of the right-of-way shall be as it was before the work started, or better. In addition, all WSDOT owned and maintained drainage systems must be, cleared of obstructions, restored, and fully operational. Any work-related clean up, restoration, necessary slope treatment / protection, or drainage restoration of WSDOT-owned right of way not completed within seven (7) calendar days of work completion, unless WSDOT approves otherwise in writing, will be performed by WSDOT at the Agency's expense. The Agency agrees to reimburse WSDOT's actual direct and related indirect costs and expenses for performing the Improvements pursuant to the provisions of Section 7.0 - Payment.
16. **SEVERANCE AND SALE OF TIMBER AND OTHER PERSONALTY — REMOVAL OF NON-MARKETABLE MATERIALS** (*Applicable to Counties and Limited Access in All Cities*). This Agreement is subject to RCW 47.12.140, and amendments thereto. This Agreement does not authorize the Agency, its' employees, contractors, or agents, any right to cut or remove any trees or timber located on WSDOT right-of way or upon state highway right of way under WSDOT jurisdiction without prior written approval from WSDOT.
17. **MAINTENANCE OF LANDSCAPING** (*Applicable to Cities ONLY*). The Agency is responsible for the maintenance of all landscaping beyond the back of the curbs or edge of pavement, and in the median of divided highways.
18. **ILLUMINATION CONSTRUCTION / INSPECTION** (*Applicable to Counties and Limited Access in All Cities*)
- **CONSTRUCTION.** The Agency shall assure that the construction of all illumination installed within WSDOT-owned highway right-of-way or highway right-of-way under WSDOT jurisdiction meets all requirements of WSDOT.
  - **ILLUMINATION DURING CONSTRUCTION.** Pre-existing illumination shall be maintained and functional at all times during construction until the new illumination is operational.
19. **TRAFFIC SIGNAL CONSTRUCTION / INSPECTION** (*Applicable to City Projects within Limited Access Areas, Projects within Cities < 27,500 Population, and all County Projects*).
- **DESIGN/CONSTRUCTION/INSPECTION.** The Agency shall assure that the design and construction of Traffic Signals and illumination on signal poles installed within WSDOT Highway right-of-way meets all requirements of WSDOT.
  - **TRAFFIC SIGNAL STANDARDS – APPROVAL.** Traffic signal standards shall be furnished and installed in accordance with the methods and materials noted in the applicable Standard Plans, pre-approved plans, or special design plans. If the proposed signal standards are not on WSDOT's PRE-APPROVED LIST (<http://www.wsdot.wa.gov/eesc/bridge/lightsignalstandards/index.cfm>). Signal Pole Shop

Drawings (Electronically, or Seven (7) sets of copies) shall be submitted to WSDOT's Construction Representative for transmittal to HQ for approval.

- **ILLUMINATION DURING CONSTRUCTION.** Pre-existing illumination shall be maintained and functional at all times during construction until the new illumination is operational.
- **TEMPORARY VIDEO DETECTION SYSTEM.** If any traffic detection loop is scheduled to be disabled, a temporary video detection system shall be completely installed and made operational prior to any associated induction loop being disabled.
- **TRAFFIC DETECTION LOOPS.** The Contractor shall notify the Area Traffic Engineer through WSDOT's Construction Representative a minimum of five working days in advance of pavement removal or grinding in areas with existing loops.

All new traffic detection loops shall be installed after grinding or prior to paving the final lift of asphalt unless otherwise approved in writing by WSDOT's Construction Representative.

If WSDOT's Construction Representative suspects that damage to any traffic detection loop, not identified in the Plans as being replaced, may have resulted from Contractor's operations or is not operating adequately, WSDOT's Construction Representative may order the Contractor to perform the field tests specified in Section 8 20.3(14) D. The test results shall be recorded and submitted to WSDOT's Construction Representative. Loops that fail any of these tests shall be replaced.

Traffic detection loops that fail the tests, as described above, and are replaced shall be installed in accordance with current WSDOT design standards and Standard Plans, as determined by WSDOT's Construction Representative.

If traffic detection loops that fail the tests, as described above, are not replaced and operational within 48 hours, the Contractor shall install and maintain interim video detection until the replacement loops are operational. The type of interim video detection furnished shall be approved by WSDOT's Construction Representative prior to installation.

- **TRAFFIC SIGNAL HEADS.** Unless approved in writing by WSDOT's Construction Representative, signal heads shall not be installed at any intersection until all other signal equipment is installed and the controller is in place, inspected, and ready for operation at that intersection, except that the signal heads may be mounted if the faces are covered with Signal Head Covering Material.
- **SIGNAL HEAD COVERING.** The signal head covering material shall be manufactured from a durable fabric material, black in color with a mesh front, and designed to fit the signal head configuration properly. The covers shall have an attachment method that will hold the cover securely to the signal in heavy wind. The covers shall be provided with a drain to expel any accumulated water.
- **TRAFFIC SIGNAL PRE-TURN-ON COORDINATION MEETING AND TESTING.** Prior to a Traffic Signal Turn-on event, the Agency/Contractor shall conduct a Pre Turn-on coordination meeting with the following Contracting Agency personnel included as invited attendees: WSDOT's Construction Representative, Electrical Inspector, Signal Operations Engineer, and Signal Maintenance Technician. The Agency/Contractor shall provide the Engineer a minimum of 5 days written notice of the proposed Pre Turn-on coordination meeting date and time. Prior to the Pre Turn-on coordination meeting, the Agency/Contractor shall complete the items of Improvements detailed in the Traffic Signal Turn-on Checklist and submit the completed checklist to WSDOT's Construction Representative. The Traffic Signal Turn-on Checklist form will be furnished to the Agency/Contractor by WSDOT's Construction Representative.

Unless approved by WSDOT's Construction Representative, the permitted hours for Pre-Turn-On coordination and testing shall be per the Approved Traffic Control Plan(s) for the specific operation.

- **TRAFFIC SIGNAL TURN-ON AND/OR SWITCHOVER OPERATIONS.** The Agency shall contact WSDOT's Construction Representative at least five (5) working days prior to scheduling a signal turn-on in order to assure that all appropriate items on WSDOT's "Traffic Signal Turn-On Checklist" are satisfactorily addressed. The Signal Turn-On or Switchover shall not occur until all applicable Checklist items are installed and/or connected. This Checklist can be located on WSDOT's web site at: <http://www.wsdot.wa.gov/Northwest/DevelopmentServices/LocalAgency.htm> (Go to: "What is needed to turn on a traffic signal?"). Prior to scheduling a turn-on date, the Agency/Contractor shall provide verification to WSDOT Construction Representative that all required testing has been satisfactorily completed.

The traffic signal turn-on procedure shall not begin until all required channelization, pavement markings, illumination, signs, and sign lights are substantially complete and operational unless otherwise allowed by WSDOT's Construction Representative.

If the Contractor is directed to turn off the traffic signal, the Contractor shall schedule a new turn-on date with the Engineer in accordance with the previously mentioned procedures.

- **PERMITTED HOURS FOR SIGNAL TURN-ON AND/OR SWITCH-OVER OPERATIONS.** Unless approved by WSDOT's Construction Representative, the permitted hours for Traffic Signal Turn-on or Switch-Over shall be per the Approved Traffic Control Plan(s) for the specific operation. Signal Switchover and Turn-On operations are permitted only on Tuesday, Wednesday, or Thursday – except in the case of an emergency. No Switchover or Turn-On operations will be permitted on Monday, Friday, weekends, holidays, or the day preceding a holiday.
- **NEW SIGNAL AHEAD/SIGNAL REVISION WARNING SIGNING**— "NEW SIGNAL AHEAD" (W20-902) or "SIGNAL REVISION AHEAD" (W20-903) signs shall be installed in advance of all affected directions of travel on the Project when a new traffic signal system is installed or when modifications to and existing signal are made. The location of the signs shall be per Section 2C.05 of the MUTCD, or as directed by WSDOT's Construction Representative. These signs are 48" X 48" black letters on orange background, and shall be post mounted. The bottom of the sign shall be mounted seven (7) feet above the pavement elevation. Each sign shall have three (3) 12" by 12" Fluorescent Orange flags or Flag Signs mounted on both sides and on top of the sign. The flags signs shall be made of aluminum, durable cloth, or plastic. The signs and flags shall stay erect for six to eight weeks or as directed by WSDOT's Construction Representative.

- 20. **INTELLIGENT TRANSPORTATION SYSTEM CONSTRUCTION/INSPECTION** *(Applicable to City Projects within Limited Access Areas, Projects within Cities < 27,500 Population, and all County Projects)*. The Agency shall assure that the construction of Intelligent Transportation Systems owned by WSDOT meets all requirements of WSDOT.
- 21. **SIGN INSTALLATION AND MAINTENANCE** *(Applicable to ALL Projects)*. All Directional, Regulatory, and Stop Signs as well as Route Markers shall be installed as per the Approved Plans, WSDOT Standard Plans, or as directed by WSDOT's Construction Representative. The DEPARTMENT shall own and maintain these signs- unless the Agency signs a Contract or Maintenance Agreement with WSDOT to perform sign maintenance.
- 22. **TRAFFIC REVISION WARNING SIGNING** *(Applicable to ALL Projects)*. When the permanent channelization of the highway is changed, "TRAFFIC REVISION AHEAD" (W20-901) signs shall be installed in advance of all affected directions of travel of the Project. The location of the signs shall be per Section 2C.05 of the MUTCD, or as directed by WSDOT's Construction Representative. These signs are 48" X 48" black letters on orange background, and shall be post mounted. The bottom of the sign shall be mounted seven (7) feet above the pavement elevation.
- 23. **REMOVAL OF PAVEMENT MARKINGS** *(Applicable to ALL Projects)*. Pavement markings to be removed shall be obliterated until blemishes caused by the pavement marking removal conform to the coloration of the adjacent pavement. Grinding to remove painted markings is only allowed prior to application of a Bituminous Surface Treatment (BST). Grinding to remove pavement markings from hot mix asphalt and cement concrete pavements is allowed to a depth just above the pavement surface, then water blasting or shot blasting shall be required to remove the remaining markings. If in the opinion of WSDOT's Construction Representative the pavement is materially damaged by pavement marking removal, such damage shall be repaired by the Contractor in accordance with Section 1-07.13(1). Sand or other material deposited on the pavement as a result of removing lines and markings shall be removed as work progresses to avoid hazardous conditions. Accumulation of sand or other material which might interfere with drainage will not be permitted.
- 24. **APPLICATION OF CHANNELIZATION PAVEMENT MARKINGS** *(Applicable to City Projects within Limited Access Areas, Projects within Cities < 27,500 Population, and all County Projects)*. Two applications of paint shall be required for all paint stripe markings as per the WSDOT Standard Specifications. Plastic Pavement Markings shall also be applied per the WSDOT Standard Specifications.
- 25. **NON-PAYMENT OF REIMBURSABLE ACCOUNT** *(Applicable to ALL City Projects)*. The Agency agrees that if it does not make payment for any WSDOT work, as provided herein, within ninety (90) calendar days after receipt of a WSDOT invoice, WSDOT may deduct and expend any monies to which the Agency is entitled to receive from the Motor Vehicle Fund as provided by RCW 47.24.050.
- 26. **ADVERTISING SIGNS** *(Applicable to Counties and Limited Access in All Cities)*. Any advertising adjacent to WSDOT Highways must be in compliance with the Scenic Vistas Act of 1971, Chapter 47.42 RCW and Chapter 468-66 WAC. Violation of this section of the statutes will be sufficient cause for cancellation of this Agreement. Advertising signs are allowed off WSDOT Highway right-of-way, subject to Local Codes and Regulations.





**WSDOT Notes:**

1. Notify WSDOT CTCO 5 days before starting work by contacting 206-440-4338 or emailing Jennifer.Baldehy@wsdot.wa.gov.
2. At time of Work, call WSDOT Radio at (206) 440-4490 when lane/shoulder is closed, and again when lane/shoulder is opened. Leave contact name and mobile phone number with WSDOT Radio
3. Notify Transit Agency(ies) & affected businesses 5 days prior to beginning Work.
4. Pedestrians and bicyclists shall be accommodated through the work zone. Assistance or signed detour shall be provided.
5. Only essential equipment and materials shall be on WSDOT Right of Way (ROW) during working Hours. No equipment or materials shall be on WSDOT ROW during non-working hours.
6. Channelization devices shall be Traffic Safety Drums with 6-inch retroreflective bands, fabricated from type 3 or type 4 or higher sheeting type, as described in Section 9-28.12 of the WSDOT Standard Specifications.
7. During non-Working hours, area shall meet criteria in WSDOT Std Specs. 1-07 23, Including, but not limited to, "drop off" protection.
8. All W-Series signs shall be 48"x48" Black on Orange and retroreflective.
9. All R-Series signs shall be Black on White.
10. Flagging Station shall be visible from W20-7A. Add additional W20-7A if needed due to limited sight distance and retroreflective.
11. Traffic Holds shall not exceed 5 minutes per occurrence. If longer than 5 minutes is needed, traffic shall be allowed to clear prior to the next attempt.
12. When side street or cross street fall within the sign sequence, signs shall also be placed on side streets.
13. CLOSURE DAYS AND TIMES Shall be Deferred to the LOCAL AGENCY

**Holiday Impacts:**

No closures will be allowed from noon the day prior to a holiday or holiday weekend through noon the day following a holiday or holiday weekend. It is a holiday weekend when the holiday falls on Friday, Saturday, Sunday, or Monday.

**Jurisdiction:**

Approval limited to traffic control devices located within WSDOT right-of-way. Devices on City or County roads are the responsibility of the City or County.

**APPROVAL EXPIRES 6 MONTHS  
AFTER DATE SIGNED**

**ACCEPTED AS NOTED**  
4/6/26  
*Krissy Kaufman*  
WSDOT TRAFFIC OPERATIONS

Within WSDOT Right-of-Way/Limited Access Only  
LOCAL AGENCY Shall Also Accept

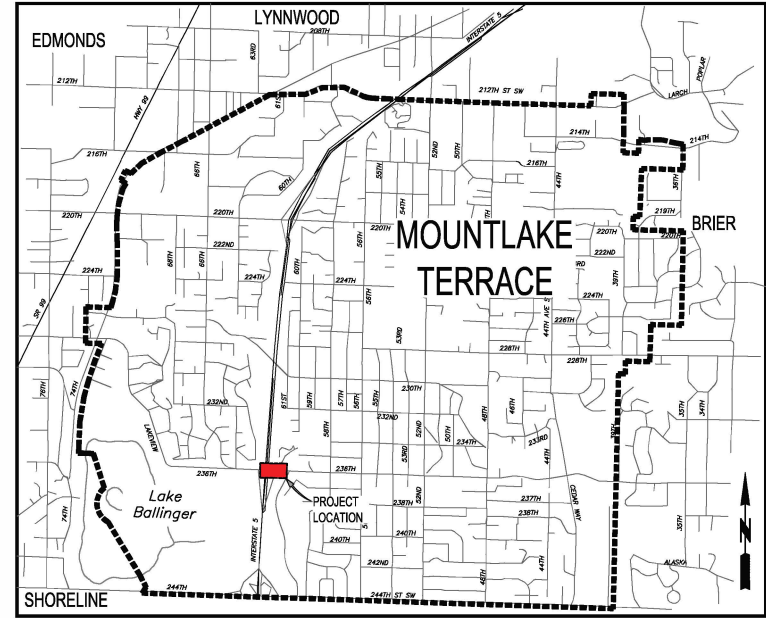

VICINITY MAP & SITE PLAN

**CITY OF MOUNTLAKE TERRACE  
TRANSIT CONNECTION CORRIDOR PROJECT**

PROJECT NO. C2202

PROJECT MANAGER: DONNELLE DAYAO,  
PARKS PROJECT MANAGER

236TH STREET SW TRAFFIC CONTROL PLAN FOR  
SIDEWALK RECONSTRUCTION ON SOUTH SIDE OF 236TH.

Exhibit C  
NWS-2575-MLT  
MLT Ped Plaza  
Page 1 of 2



CITY OF MOUNTLAKE TERRACE  
TRANSIT CONNECTION CORRIDOR PROJECT  
TRAFFIC CONTROL PLAN VICINITY MAP

PROJECT NO.	T001
PROJECT NAME	TRANSIT CONNECTION CORRIDOR PROJECT
PROJECT LOCATION	236TH STREET SW, MOUNTLAKE TERRACE, WA
PROJECT DATE	4/6/2025
PROJECT STATUS	IN PROGRESS
PROJECT MANAGER	DONNELLE DAYAO
PROJECT ENGINEER	DAVID J. BROWN
PROJECT ARCHITECT	DAVID J. BROWN
PROJECT CONSULTANT	DAVID J. BROWN
PROJECT CONTRACTOR	DAVID J. BROWN
PROJECT OWNER	CITY OF MOUNTLAKE TERRACE
PROJECT FUNDING	LOCAL FUNDS
PROJECT BUDGET	\$0
PROJECT RISK	LOW
PROJECT COMPLIANCE	COMPLIANT
PROJECT NOTES	

**LEGEND**

- EXISTING SIGN
- CLASS A SIGN
- CLASS B SIGN
- TRAFFIC SAFETY DRUM
- WORK ZONE
- TYPE 3 BARRICADE
- SIGNALIZED INTERSECTION
- UNIFORMED POLICE OFFICER (UPO)

**APPROVAL EXPIRES 6 MONTHS AFTER DATE SIGNED**

**ACCEPTED AS NOTED**  
4/6/26  
*Krissy Kaufman*  
**WSDOT TRAFFIC OPERATIONS**  
Within WSDOT Right-of-Way/Limited Access Only  
Local Agency *Shall Also Accept*

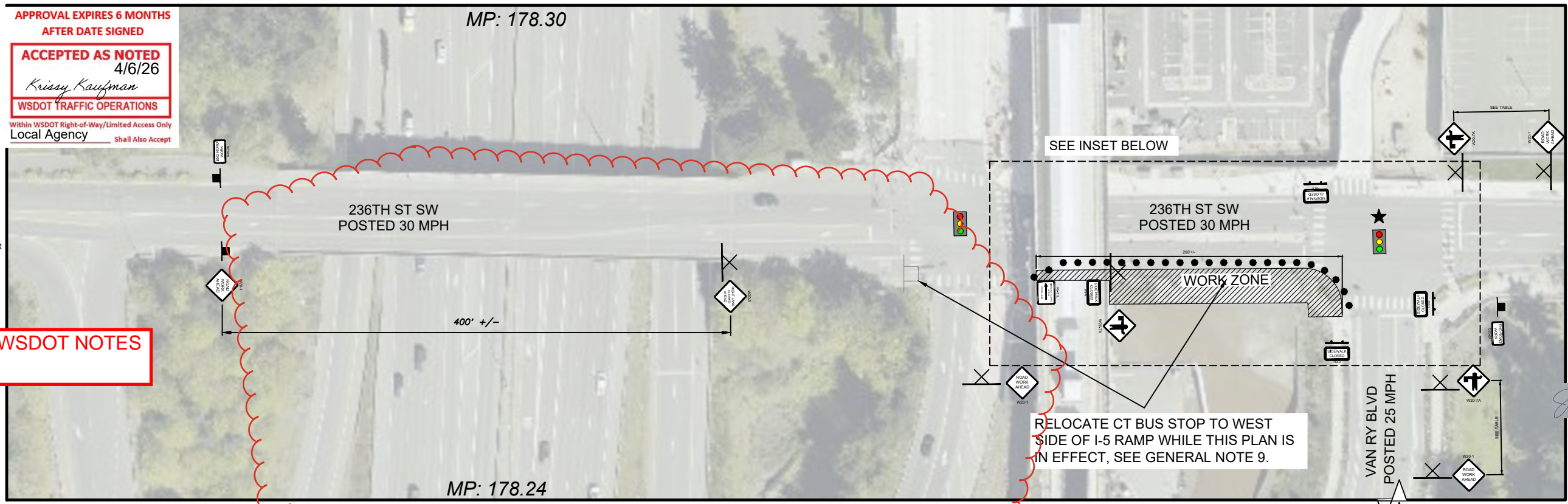

**SEE PAGE 1 FOR WSDOT NOTES**

**GENERAL NOTES:**

1. TRAFFIC CONTROL PLAN APPROVED FOR USE 24 HRS/7 DAYS PER WEEK.
2. CONTRACTOR TO FIELD VERIFY AND ADJUST SIGNAGE AS NECESSARY. SIGN AND CHANNELIZATION SPACING, TAPER LENGTHS, BUFFER SPACE, AND ALL OTHER TRAFFIC CONTROL PARAMETERS SHALL FOLLOW THE CURRENT EDITION OF THE MANUAL OF UNIFORM TRAFFIC CONTROL DEVICES (MUTCD). ADDITIONAL SIGNAGE MAY BE REQUIRED AS DIRECTED BY THE ENGINEER.
3. REVISIONS TO TRAFFIC CONTROL PLANS TO BE USED DURING CONSTRUCTION SHALL BE SUBMITTED 10 WORKING DAYS PRIOR TO USE.
4. SEE SPECIAL PROVISIONS FOR NOTIFICATION REQUIREMENTS FOR OTHER AFFECTED AGENCIES.
5. FOR NIGHTTIME WORK ALL TRAFFIC CONTROL DEVICES SHALL FOLLOW MUTCD REQUIREMENTS FOR NIGHTTIME USE.
6. CONTRACTOR SHALL MAINTAIN 11 FT WIDE TRAVEL LANES AT ALL TIMES FOR ALL LANES OPEN TO TRAFFIC.
7. ALL SHALL BE BLACK ON ORANGE UNLESS OTHERWISE SPECIFIED.
8. ALL W- AND R-SERIES SIGN SIZES AS NOTED.
9. CONTACT COMMUNITY TRANSIT FACILITIES PLANNER SHAWN NAKANO, (425) 521-5329 FIVE (5) DAYS PRIOR TO CLOSING OR RELOCATING CT BUS STOPS.

OWNER: CITY OF MOUNTLAKE TERRACE  
CONTACT: DONNELLE DAYAO, PROJECT MANAGER  
DDAYAO@MLTWA.GOV  
425.582.3832

TRAFFIC CONTROL SUPERVISOR (ASSIGNED BY CONTRACTOR AFTER AWARD):

NAME: \_\_\_\_\_

TEL: \_\_\_\_\_

EMAIL: \_\_\_\_\_

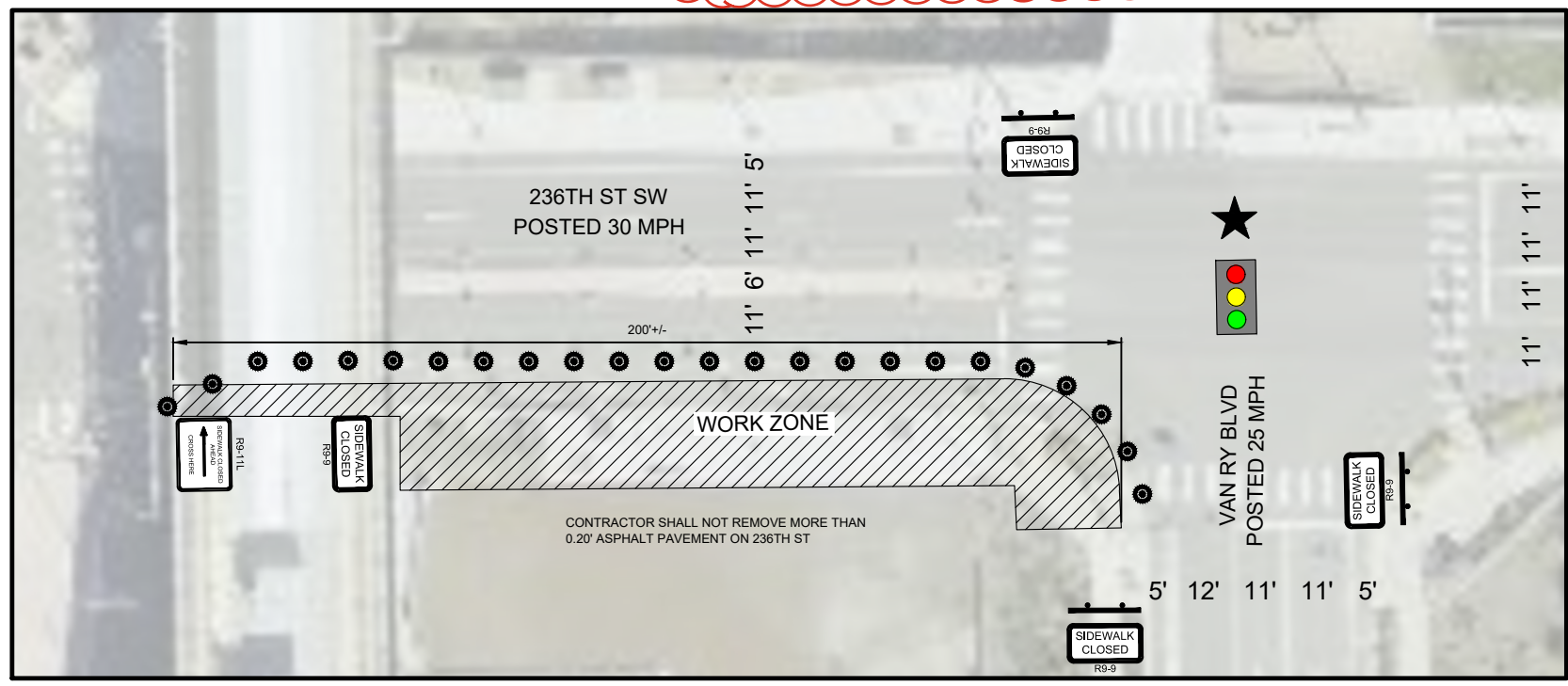

**WORK ZONE AND PEDESTRIAN SIGNS**

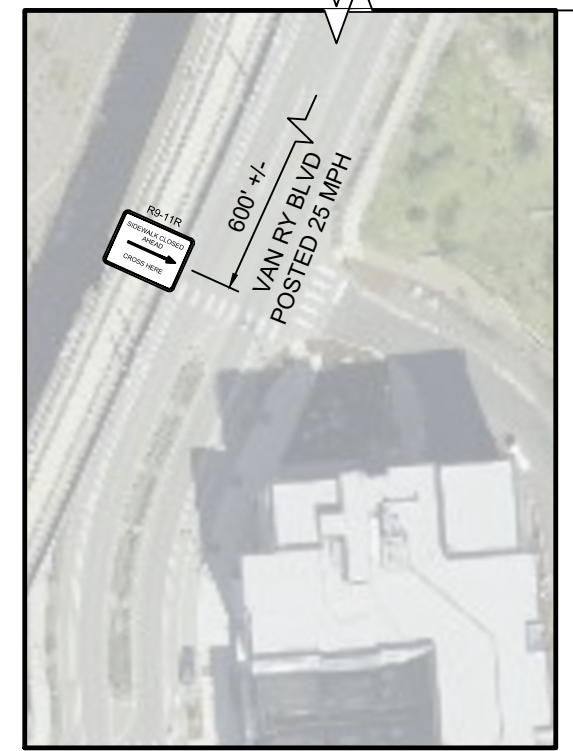

**PED DETOUR, VAN RY BLVD SOUTH**

TCP PREPARED BY:  
JEFF RIVERS, Jrivers@mltwa.gov  
425.758.5970

LANE WIDTH, FEET	MINIMUM TAPER LENGTH (L) IN FT				
	POSTED SPEED (MPH)				
	25	30	35	40	45
10	105	150	205	265	450
11	115	165	225	295	495
12	125	180	245	320	540

MPH	CHANNELIZATION DEVICE SPACING (FT)	
	TAPER	TANGENT
50/70	40	80
35/45	30	60
25/30	20	40

	SIGN SPACING = X	
	RURAL ROADS	URBAN ARTERIALS
45/55 MPH	500 FT +/-	350 FT +/-
25/30 MPH	200 FT +/-	

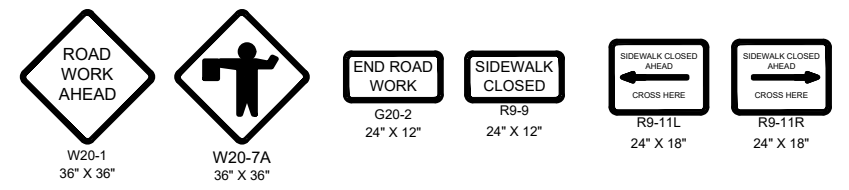

WSDOT APPROVAL STAMP  
2" x 2"

**CITY OF MOUNTLAKE TERRACE**  
ENGINEERING SERVICES DEPARTMENT  
29304 68TH AVE W  
MOUNTLAKE TERRACE, WA 98043  
(425) 775-1161  
FAX (425) 775-0420



**CITY OF MOUNTLAKE TERRACE**  
TRANSIT CONNECTION CORRIDOR PROJECT  
TRAFFIC CONTROL PLAN

DATE	DATE
APPROVED BY: _____	DATE: _____
PROJECT ENGINEER: _____	DATE: _____
DESIGNER: _____	DATE: _____
DRAWN BY: _____	DATE: _____
PROJECT NO: TC02	PROJECT TITLE: TRANSIT CONNECTION CORRIDOR PROJECT
DRAWING NO: _____	SCALE: _____

IN ENGINEER CONSTRUCTION PROJECTS 2021 (2202-TRANSIT CONNECTION CORRIDOR) - DESIGN (MST TCS) (2202\_TCP\_DRAWING) REV. 01/27/2021 11:58:05 AM