



**DATE:** October 10, 2019

**Addendum No. 1**

**TO:** PLAN HOLDERS

**PREPARED BY:** Michael Gamble Oct 10 2019 11:48 AM  
Michael Gamble

**APPROVED BY:** Mats Halvardson Oct 10 2019 1:22 PM P.E.  
Mats Halvardson

FINAL ELECTRONIC DOCUMENT AVAILABLE UPON REQUEST

**SUBJECT:** US101: Gold Beach (Rogue River) Bridge Project  
Oregon Coast Highway  
Curry County  
Structure  
(Bids Closing October 17, 2019)

**The following change is made to the Project Bid Booklet:**

1. The following change is made to the Project Bid Items:

Quantity changes:

| <u>Number</u> | <u>Item</u> | <u>Quantity</u> |            |
|---------------|-------------|-----------------|------------|
|               |             | <u>Original</u> | <u>New</u> |
| 0110          | Flaggers    | 1,400           | 2,000      |

Make a copy of and use the new attached Bid Schedule if submitting a paper Bid. If submitting an electronic Bid through BidExpress®, use the Zip file available on BidExpress® that includes the new updates in the attached Bid Schedule. A Bid **not** including this new Bid Schedule **will be rejected as non-responsive**.

**The following change is made to the Project Special Provisions:**

1. Subsection 01262.80 General - This subsection is replaced with the following subsection:

**01262.80 General** - No measurement of quantities will be made for work performed under this section.

The estimated quantities of zinc primer coating are:

| <b>Coating</b>   | <b>Location</b> | <b>Quantity<br/>(Square Yard)</b> |
|------------------|-----------------|-----------------------------------|
| Zinc Primer Coat | See plans       | 276                               |

Make copies of the new attached Bid Schedule to replace the Bid Schedule in the Project Special Provisions.

**The following change is made to the Project Plans:**

1. Plan sheet J01 is replaced with revised plan sheet J01.

This change will be included in the Contract for this Project. It is understood that your Bid will be submitted accordingly.

mg:MH

Attachments: New Bid Schedule  
Revised Plan Sheet

**OREGON DEPARTMENT OF TRANSPORTATION  
BID SCHEDULE**

**CONTRACT NO.:** 15166      **PROJECT:** US101: GOLD BEACH (ROGUE RIVER) BRIDGE  
**PROJECT KEY:** 20695      **ADDENDUM NO.:** 1

| ITEM NO   | ITEM DESCRIPTION  | QUANTITY AND UNITS | UNIT PRICE   | BID AMOUNT   |
|---|---|--------------------|--------------|--------------|
|   |   |                    | (IN FIGURES) | (IN FIGURES) |
| <b>SECTION: 0001 TEMPORARY FEATURES AND APPURTENANCES</b> |   |                    |              |              |
| 0010  | 0100-0101000T<br>TRAINING   | 500.00<br>HOUR     | 20.00        | 10,000.00    |
| 0020  | 0210-0100000A<br>MOBILIZATION                                     | ALL<br>LUMP SUM    |              |              |
| 0030  | 0225-0100000A<br>TEMPORARY PROTECTION AND<br>DIRECTION OF TRAFFIC | ALL<br>LUMP SUM    |              |              |
| 0040  | 0225-0102000J<br>TEMPORARY SIGNS                                  | 490.00<br>SQFT     |              |              |
| 0050  | 0225-0104000E<br>TEMPORARY BARRICADES, TYPE II                    | 16.00<br>EACH      |              |              |
| 0060  | 0225-0105000E<br>TEMPORARY BARRICADES, TYPE<br>III                | 4.00<br>EACH       |              |              |
| 0070  | 0225-0141600F<br>PEDESTRIAN CHANNELIZING<br>DEVICES               | 200.00<br>FOOT     |              |              |
| 0080  | 0225-0145000E<br>TEMPORARY PLASTIC DRUMS                          | 20.00<br>EACH      |              |              |
| 0090  | 0225-0149000E<br>TEMPORARY FLEXIBLE PAVEMENT<br>MARKERS           | 500.00<br>EACH     |              |              |
| 0100  | 0225-0164000E<br>PORTABLE CHANGEABLE<br>MESSAGE SIGNS             | 2.00<br>EACH       |              |              |
| 0110  | 0225-0168000T<br>FLAGGERS   | 2,000.00<br>HOUR   |              |              |
| 0120  | 0225-0168100E<br>FLAGGER STATION LIGHTING                         | 5.00<br>EACH       |              |              |
| 0130  | 0253-0106000A<br>TEMPORARY WORK ACCESS AND<br>CONTAINMENT         | ALL<br>LUMP SUM    |              |              |
| 0140  | 0290-0100000A<br>POLLUTION CONTROL PLAN                           | ALL<br>LUMP SUM    |              |              |

**OREGON DEPARTMENT OF TRANSPORTATION  
BID SCHEDULE**

**CONTRACT NO.:** 15166

**PROJECT:** US101: GOLD BEACH (ROGUE RIVER) BRIDGE

**PROJECT KEY:** 20695

**ADDENDUM NO.:** 1

| ITEM NO | ITEM DESCRIPTION                       | QUANTITY AND UNITS | UNIT PRICE   | BID AMOUNT   |
|---------|--|--------------------|--------------|--------------|
|         |  |                    | (IN FIGURES) | (IN FIGURES) |
| 0150    | 0290-0102000A<br>WORK CONTAINMENT PLAN | ALL<br>LUMP SUM    |              |              |

**SECTION: 0002 BRIDGE NO. 01172**

|      |  |                  |  |  |
|------|--|------------------|--|--|
| 0160 | 0538-0100000F<br>INJECT AND SEAL CRACKS                  | 935.00<br>FOOT   |  |  |
| 0170 | 0556-0100000J<br>CLASS 2 PREPARATION                     | 304.20<br>SQYD   |  |  |
| 0180 | 0556-0300000J<br>FURNISH MPCO MATERIAL                   | 6,083.00<br>SQYD |  |  |
| 0190 | 0556-0500000J<br>CONSTRUCT MPCO                          | 6,083.00<br>SQYD |  |  |
| 0200 | 0567-0103000A<br>TITANIUM SYSTEM, 0.625 INCH<br>DIAMETER | ALL<br>LUMP SUM  |  |  |
| 0210 | 0567-0104000A<br>TITANIUM SYSTEM, 0.750 INCH<br>DIAMETER | ALL<br>LUMP SUM  |  |  |
| 0220 | 0585-0200000A<br>ASPHALTIC PLUG SEALS                    | ALL<br>LUMP SUM  |  |  |
| 0230 | 0585-0206000A<br>POURED SEALS                            | ALL<br>LUMP SUM  |  |  |
| 0240 | 0585-0206000A<br>FILLED JOINTS                           | ALL<br>LUMP SUM  |  |  |
| 0250 | 0593-0101000A<br>PREPARE AND COAT CONCRETE<br>STRUCTURES | ALL<br>LUMP SUM  |  |  |
| 0260 | 1220-0100000E<br>REPAIR DAMAGED REINFORCING<br>BARS      | 1.00<br>EACH     |  |  |
| 0270 | 1235-0400000J<br>REPAIR DAMAGED CONCRETE                 | 5.50<br>SQYD     |  |  |

**SECTION: 0003 PERMANENT TRAFFIC SAFETY AND GUIDANCE DEVICES**

**OREGON DEPARTMENT OF TRANSPORTATION  
BID SCHEDULE**

**CONTRACT NO.:** 15166

**PROJECT:** US101: GOLD BEACH (ROGUE RIVER) BRIDGE

**PROJECT KEY:** 20695

**ADDENDUM NO.:** 1

| ITEM NO | ITEM DESCRIPTION  | QUANTITY AND UNITS | UNIT PRICE   | BID AMOUNT   |
|---------|---|--------------------|--------------|--------------|
|         |   |                    | (IN FIGURES) | (IN FIGURES) |
| 0280    | 0855-0103000E<br>BI-DIRECTIONAL YELLOW TYPE<br>1AR MARKERS                        | 53.00<br>EACH      |              |              |
| 0290    | 0865-0160000F<br>THERMOPLASTIC, EXTRUDED OR<br>SPRAYED, SURFACE, NON-<br>PROFILED | 8,100.00<br>FOOT   |              |              |

**TOTAL BID:** \_\_\_\_\_

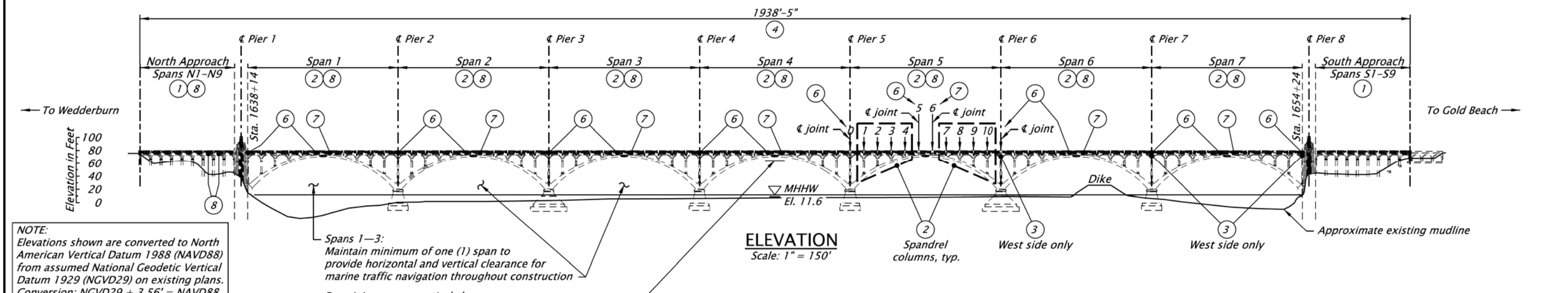
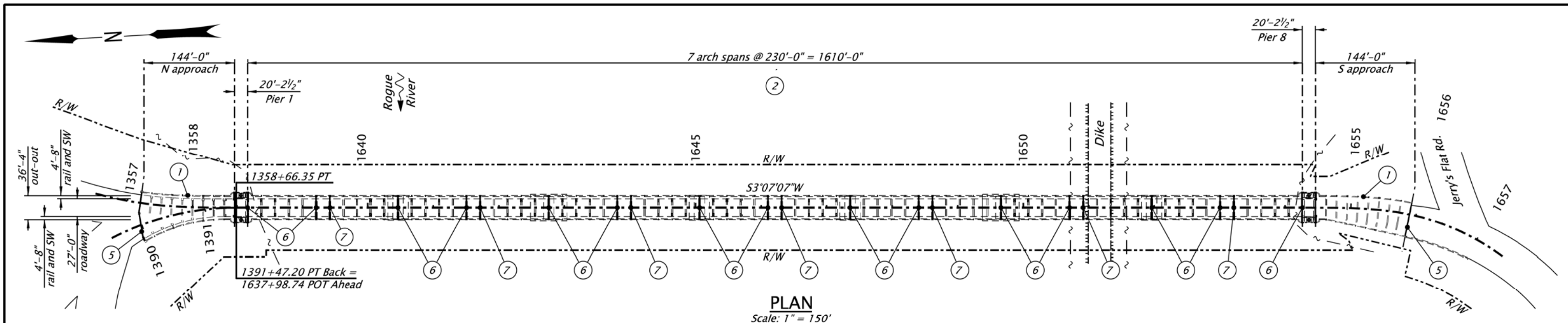

**NOTE:**  
Elevations shown are converted to North American Vertical Datum 1988 (NAVD88) from assumed National Geodetic Vertical Datum 1929 (NGVD29) on existing plans. Conversion: NGVD29 + 3.56' = NAVD88

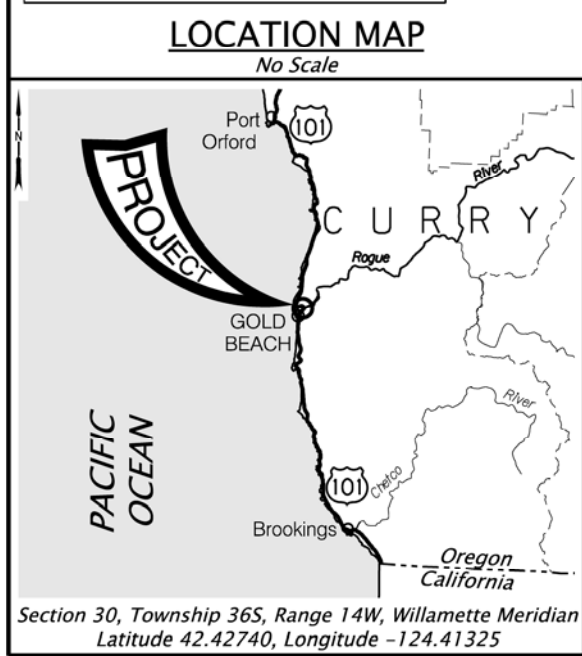

**NOTE:**  
Spans 1-3: Maintain minimum of one (1) span to provide horizontal and vertical clearance for marine traffic navigation throughout construction  
Remaining spans: vertical clearance is 6'-0" below bottom of arch apex

- WORK ITEMS:**
- ① Strengthen exterior beam A, at east side, north and south approach spans. Paint repair area with zinc rich primer. See special provisions 00567 and 01262, and sheet J03.
  - ② Strengthen arch Spans 1-7: Beam K and Beam L at spandrel columns 1-4 and 7-10 locations. Paint repair with zinc rich primer. See special provisions 00567 and 01262, and sheet J05.
  - ③ Repair west arch spandrel curtain wall at expansion scoring joint. Paint repair with zinc rich primer. See special provisions 00542 and 01262; sheet J07; and standard drawings BR500 and BR505.
  - ④ Place MPCO. See special provision 00556.
  - ⑤ Sawcut and fill joint with hot applied sealant at north and south approach spans. See sheet J08.
  - ⑥ Replace asphaltic plug joint seal on roadway and poured joint seal at curb and sidewalk. See special provision 00585 and sheet J08.
  - ⑦ Poured joint seal. See special provision 00585 and sheet J08.
  - ⑧ Epoxy inject cracks 0.016 or greater in width on existing exterior Beam A north approach, and Spans N7 and N8 (3 interior beams each span), and Beam K. See special provisions 00538 and 01262 and sheet J08.

**NOTE:**  
Protect existing utilities in place.

| No. | DATE    | REVISIONS                          | BY  |
|-----|---------|------------------------------------|-----|
| ①   | 2019-10 | Work Item #8 rewritten for clarity | MOH |
|     |         |                                    |     |
|     |         |                                    |     |

|   |                         |
|---|-------------------------|
| ACCOMPANIED BY DWGS:<br>J02 through J10;<br>BR140 and BR157   | STRUCTURE NO.<br>01172  |
| NOT FOR CONSTRUCTION - INFORMATIONAL DWGS:<br>3874 - 3890, 4069, 4070,<br>33357 - 33362,<br>59778 - 59795,<br>68586 - 68592 | BDS DWG NO.<br>103666   |
|   | CALC. BOOK<br>7146      |
|   | HWY: 009<br>M.P.: 327.7 |
|   | COUNTY<br>Curry         |
|   | DATE<br>July 2019       |

**REGISTERED PROFESSIONAL ENGINEER**  
58867  
DIGITALLY SIGNED Oct 10 2019 10:52 AM  
OREGON  
JANUARY 23, 2001  
MATS O. HALVARDSON

**OREGON DEPARTMENT OF TRANSPORTATION**  
Rogue R\_Hwy 9 (Gold Beach)  
**US101: GOLD BEACH (ROGUE RIVER) BRIDGE PROJECT**  
HIGHWAY 9 (HWY 101) MP 327.51 TO 327.88  
CURRY COUNTY  
Designer: Mats O. Halvardson, PE      Reviewer: Robert E. Grubbs, PE  
Drafter: J. Tilman      Checker: Kelly B. Freeman, PE  
**PLAN AND ELEVATION**      SHEET NO. J01

**SCALE WARNING**  
IF THIS SCALE LINE DOES NOT MEASURE ONE INCH, THEN DRAWING IS NOT TO SCALE